

SAP 2010 FLOORPLAN

KEY:

- (B) - 3 x 2 Bronze Stand
- (S) - 3 x 2 Silver Stand
- (G) - 4 x 3 Gold Stand
- Shell Scheme Wall —
- No Wall or Fascia —
- 3 x Pod -

Side Entrance

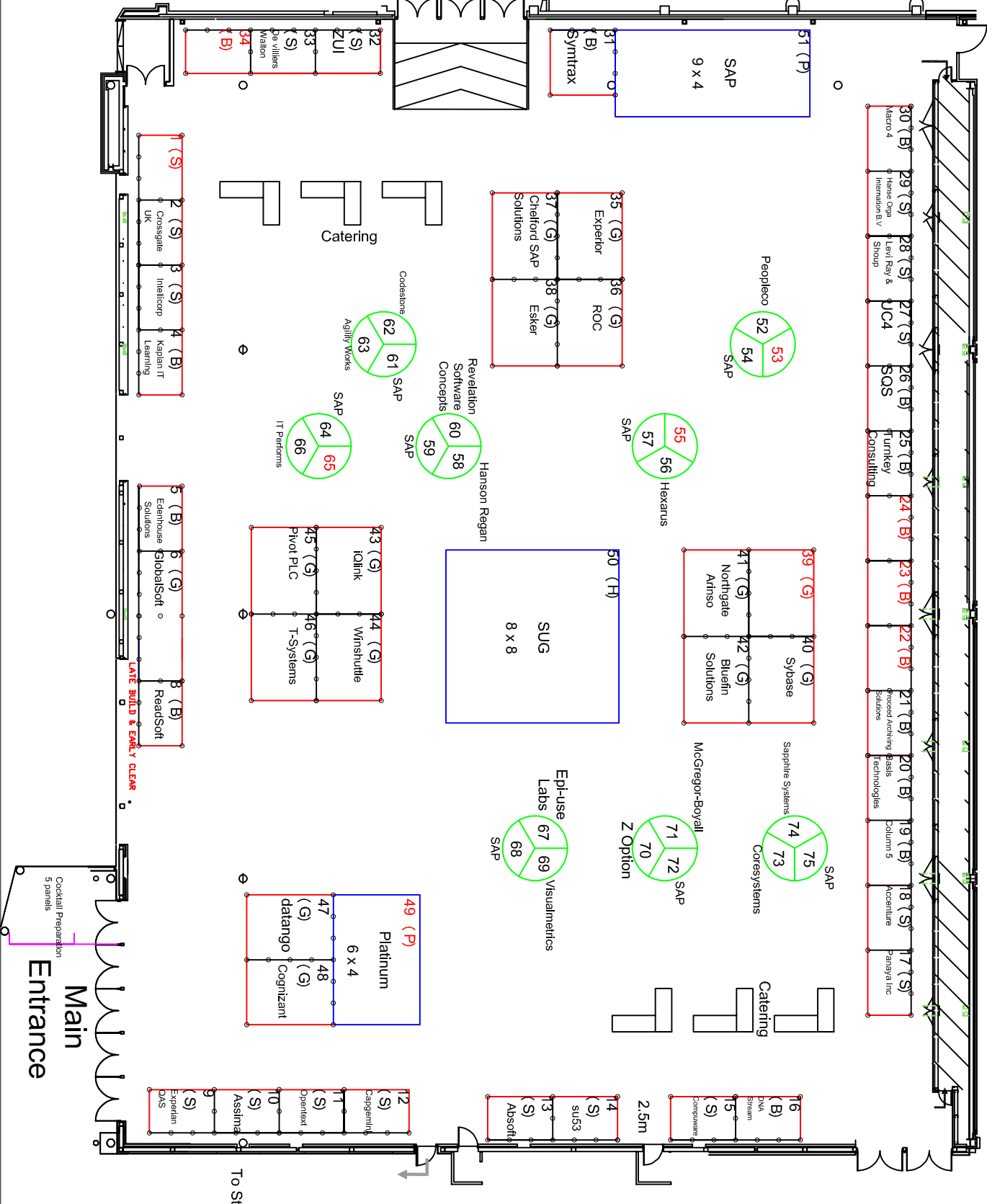

Main Entrance

To St

Cocktail Preparation
5 panels

LATE BUILD & EARLY CLEAR

30 (B) Macro 4
29 (S) Hulse Orga
28 (S) Levi Ray & Shoup
27 (S) JUC4
26 (B) SAS
25 (B) Turnkey Consulting
24 (B) SAS
23 (B) SAS
22 (B) SAS
21 (B) Process Archiving Solutions
20 (B) Basis Technologies
19 (B) Column 5
18 (S) Accenture
17 (S) Paraya Inc

51 (P) SAP 9 x 4
31 (B) Syntrax

35 (G) Expertor
37 (G) Chelford SAP Solutions
36 (G) ROC
38 (G) Esker

52 53 54 Peopleco SAP
55 56 57 Hexarus SAP
39 (G) Sybase
41 (G) Northgate
42 (G) Bluefin Solutions
40 (G) Sybase

62 61 63 Codestone Agility Works
60 58 59 Revelation Software Concepts SAP
64 65 66 SAP IT Performs

43 (G) IQlink
45 (G) Pivot PLC
44 (G) Winshuttle
46 (G) T-Systems

50 (H) SUG 8 x 8

74 75 73 SAP CoreSystems
71 72 70 Z Option
67 69 68 Epi-use Labs Visualmetrics

49 (P) Platinum 6 x 4
47 (G) datango
48 (G) Cognizant

2 (S) Capgemini
1 (S) Openext
10 (S) Assima
9 (S) Experian
8 (S) D&S

32 (S) ZUI
33 (S) de Villiers
34 (S) Watson
37 (B)

5 (B) Edinhouse Solutions
6 (G) GlobalSoft
7 (B) ReadSoft

2 (S) Crossgate UK
3 (S) Intellicorp
4 (B) Kaplan IT Learning

6 (B) DVA
5 (S) Stream
4 (S) Compuserve
3 (S) sus3
2.5m
4 (S) Abssoft

Catering
Catering
Catering